

SANMIG 400MP

DC Multi-Process Welding

Tough, Compact and Light Weight



Excellent Performance: Embedded microprocessor with digital controls, delivering full multi process CC/CV, CV Pulse with perfectly smooth, stable arc characteristics for MIG solid and Flux cored wires, Air Carbon Arc cutting and Gouging, E6010 Cellulose and low hydrogen electrodes.

MIG Pulse: Preset Pulse programs for Mild Steel, Stainless Steel, Aluminum and Silicon Bronze.

Primary Smart Switch: Prevents damage to the internal components if installed to improper voltage. Multi voltage 208-230/460 1 or 3 phase providing maximum flexibility.

Thermal Overload Protection: Indicator alerts the operator if duty cycle is exceeded or airflow is blocked.

Remote 14pin Receptacle Fitted: Makes compatibility of SanRex, competitive wire feeders and remote devices simple.

Excellent Portability: Lightweight, less than 65 lbs.

IP23S: Suitable for outdoor use.

Digital Meters: Voltage and Amperage: Preview and Hold capability.

Heat sensing fan: Operates as needed to cool components & reduce airborne contaminants pulled through the power source.

Easy to use: Simple, user friendly set-up and operation.

Smart Warning Diagnostics: Alerts operator to power supply abnormalities.

Standards Compliant Integrated VRD: Voltage Reduction Device reduces the OCV when the power supply is not in use. This all but eliminates the risk of electrocution to the operator from the secondary welding circuit.

Job Save & Load: Allows operator to store up to 5 exact optimized welding parameters then digitally recall them with perfect repeatability.

Lift Start TIG: Provides TIG arc starting without use of high frequency.

Hot Start: Adjustable Hot Start for optimized starting performance.

Arc Control: Adjustable Arc control for optimized welding performance.

Inductance Control: Fine tuning control for optimized MIG welding performance.

Dinse Twist Lock Output Terminals: Allow for easy polarity changing and cable connection.

Quick Specifications

Processes

STICK (SMAW)
TIG (GTAW) Lift
MIG (GMAW), Flux Cored (FCAW)
Pulse MIG (GMAW-P)
Air Carbon Arc Cutting/Gouging (CAG)

Industrial Manufacturing, Contractors,
Installation/Repair.

Input Voltage

208-230/460 VAC 1/3 Phase

Input Frequency

50/60 Hz

Rated Output @ Duty Cycle

400A/36V @ 25%
300A/32V @ 60%

Output Range

5-400A DC

Weight

55.6 lb (25.22 kg)

Package Includes

SANMIG 400MP
Power Cord
2 ea Dinse 50mm plugs

Order Information

Part No: ID-4000CP-U1E
Description: SANMIG 400MP

3 Year Warranty

SanRex

Customer Care
Tel: 516-625-1313
Fax: 516-625-8845

SANREX CORPORATION
PORT WASHINGTON, NY, USA

www.sanrex.com
SANARG 400MP
Form No.:071418400MP

Control Panel

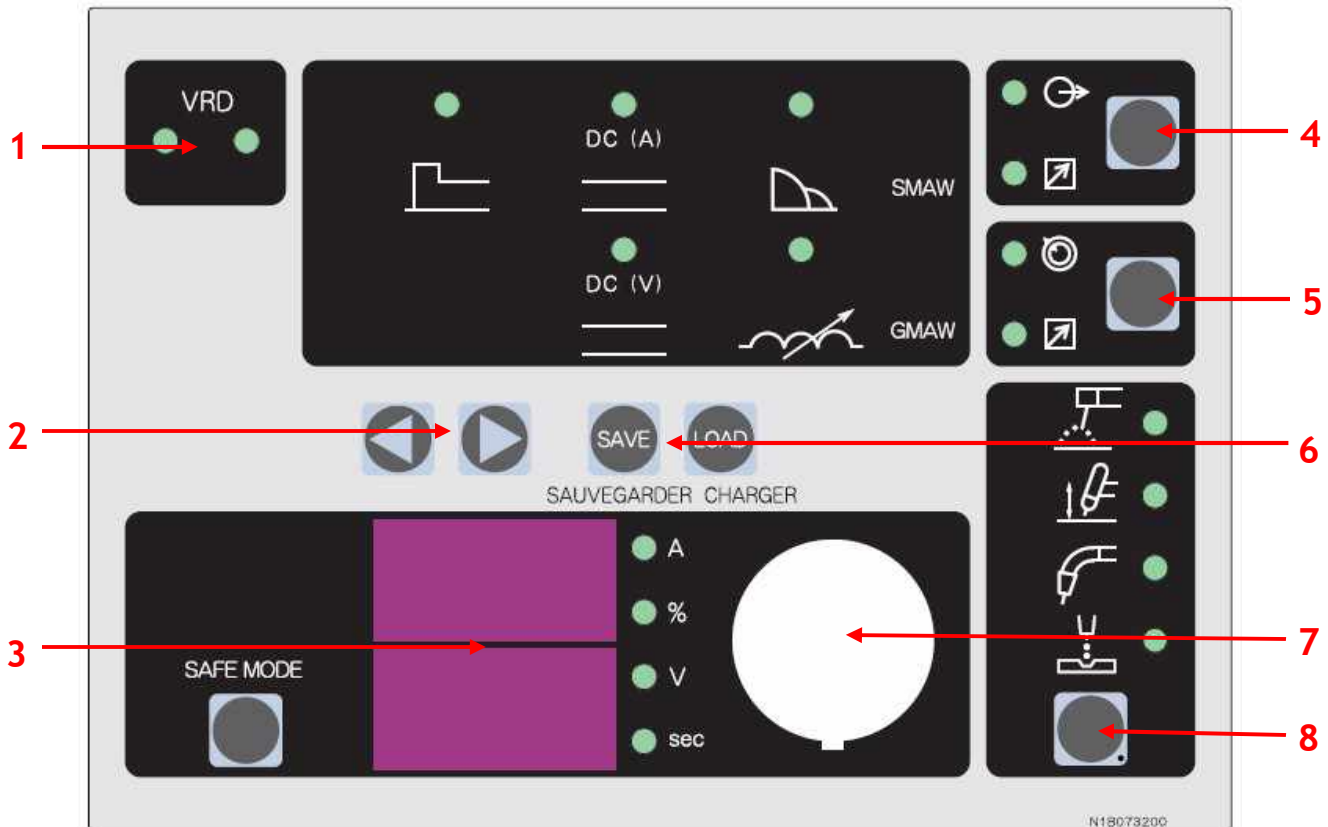

1. VRD - (Voltage Reduction Device) lights indicate on or off.
2. Scroll buttons - used to select the parameter to be set. The LED's show which function is being adjusted on the weld sequence graph.
3. Digital LED display - welding amperage and parameter values are displayed in this window. Internal warnings such as over temperature, low or high input voltage applied are signaled to the operator by a warning sound and error message on the screen.
4. Remote contactor function - pressing this button enables remote contactor on or off.
5. Remote current function - pressing this button enables remote current.
6. Save/Load Buttons - By using the Save & Load buttons the operator can easily save up to 5 welding parameter programs.
7. Control knob - allows the operator to adjust the output amperage within the entire range of the power source, also used to set each parameter value.
8. Process functions - pressing this button scrolls through the output process modes (Stick, Lift TIG, MIG).

SANMIG 400MP

DC Multi-Process Welding

Features



Recessed Control Panel
Simple to use operator interface with protective cover.

Flow Through Cooling
Heat Sensing Fan.

Output Terminals
Dinse Twist Lock.

Primary Smart Switch
Multi voltage 208-230/460
1 or 3 phase providing maximum flexibility.

Heavy Duty Case
ABS High Density Plastic.

14 Pin Remote Receptacle
Easy to connect.

Specifications

400MP	
Input Voltage 208-230/460V, 3 Phase	Primary Cable Length 10 ft.
Rated Output @ Duty Cycle 400A/36V @ 25% 300A/32V @ 60%	Output Range 5–400A
Input Frequency 50/60 Hz	OCV 65
Lift Mode Short Current 25A	Weight 55.6 lb (25.22 kg)
Approvals CSA (Pending); IP23S, IEC 60974-1 (CE)	Dimensions (HxWxD) 16.5 x 8.3 x 17.7 in (420 x 210 x 450 mm)

Input Voltage (VAC)										
	Duty Cycle	Output Ams	OCV	Output Voltage	No. Phase	208 Input Amps	230 Input Amps	460 Input Amps	kVA	kw
Output	25%	400	65	36	3	67	60	30	34	18
Output	60%	300	65	32	3	44	40	20	16	12
No Load	-	-	-	-	3	1.4	1.1	0.7	0.5	0.13
Output	25%	300	65	32	1	96	87	-	20	12
Output	60%	230	65	29	1	67	60	-	13.9	8.3
No Load	-	-	-	-	1	2.5	1.8	-	0.5	0.13

Ordering Information

Product	Part Number	Description
SANMIG 400M	ID-4000C-U1E	Power Supply includes 2 ea Dinse Plugs & 10ft. Primary Cable.

Accessories

Note: Kits do not include Power Supply.

MIG Kit w/Sky 4	400M-MK1	Includes SKY4 Wire Feeder, 4' Coax, 12' 250A MIG Gun & 10 tips, 13' Work Lead, Regulator Flowmeter & running gear/Cylinder Rack. (When ordering specify 0.035 or 0.045 wire)
MIG Kit w/Sky 4	400M-MK2	Includes SKY4 Wire Feeder, 4' Coax, 12' 350A MIG Gun & 10 tips, 13' Work Lead, Regulator Flowmeter & running gear/Cylinder Rack. (When ordering specify 0.035 or 0.045 wire)
MIG Kit w/Sky 4HD	400M-HDMK1	Includes SKY 4HD Wire Feeder, 4' Coax, 12' 250A MIG Gun & 10 tips, 13' Work Lead, Regulator Flowmeter & running gear/Cylinder Rack. (When ordering specify 0.035 or 0.045 wire)
MIG Kit w/Sky 4HD	400M-HDMK2	Includes SKY 4HD Wire Feeder, 4' Coax, 12' 350A MIG Gun & 10 tips, 13' Work Lead, Regulator Flowmeter & running gear/Cylinder Rack. (When ordering specify 0.035 or 0.045 wire)
MIG Kit w/Sky 4HD	400MP-HDMK1	Includes SKY4 HD Wire Feeder, 4' Coax, 12' 450A MIG Gun & 10 tips, 13' Work Lead, Regulator Flowmeter & running gear/Cylinder Rack. (When ordering specify 0.035 or 0.045 wire)
 Running Gear	MS1009	Heavy Duty Single/Dual Bottle Universal Welding Cart is designed to carry one bottle of gas up to 10 inches in diameter and up to 300 cu. Ft.; or two separate bottles of gas up to 7-1/2 inches in diameter or 150 cu. Ft each. The bottom shelf has an 18 inch clearance.

Wire Feeder Options

SANFEED SKY 4

- EURO Gun connection
- Large 4 Roll System.
- Digital Volt and Amperage Meters
- Interconnection Coaxial cable
- 0.023" – 5/64" Solid and Flux-cored wires.

SANFEED SKY 4HD

- TWECO Gun connection
- Large 4 driven Drive Roll System
- Digital Volt and Amperage Meters
- Interconnection Coaxial cable
- 0.023" – 5/64" Solid and Flux-cored wires.



SANFEED SKY 4 & 4HD



Coaxial Cable
Includes Gas Hose, Power and control cables

